

MICRO JACKS

.015 (.38) - .021 (.53) PIN - PRESS-FIT

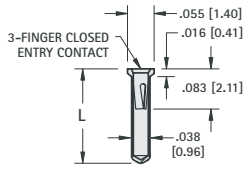

RoHS	RoHS		
GOLD	TIN/LEAD	L	Mtg. Hole Dia.
CAT. NO.	CAT. NO.	Length	
1411-1	1431-1	.140 (7.1)	.040
1411-2	1431-2	.170 (4.3)	(1.02)

.015 (.38) - .021 (.53) PIN - SOLDER MOUNT

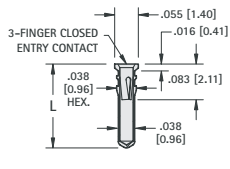

RoHS	RoHS		
GOLD	TIN/LEAD	L	Mtg. Hole Dia.
CAT. NO.	CAT. NO.	Length	
1412-1	1432-1	.140 (7.1)	.040
1412-2	1432-2	.170 (4.3)	(1.02)
1412-3	1432-3	.282 (7.1)	

- Space saving design for high density packaging
- Beryllium Copper multi-spring contact maintains retention after multiple insertions
- Ideal for mounting transistors, resistors, diodes, IC's and similar miniature components
- Custom micro jacks manufactured to your specifications
- Other platings available upon request



SPECIFICATIONS

Body: Brass, ASTM-B16

Spring: Beryllium Copper (QQ-C-533)

Plating:

Gold: .000010 per MIL-G-45204, Type II **RoHS** (RoHS Compliant)

Tin/Lead: .000200 to .000300 per MIL-T-10727, Type 1. **RoHS** (Non-RoHS Compliant)

.015 (.38) - .025 (.64) PIN - TAPER-FIT

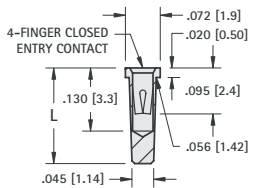

RoHS	RoHS		
GOLD	TIN/LEAD	L	Mtg. Hole Dia.
CAT. NO.	CAT. NO.	Length	
1415-1	1435-1	.160 (6.2)	.055
1415-2	1435-2	.190 (3.6)	(1.40)

.015 (.38) - .025 (.64) PIN - SOLDER MOUNT

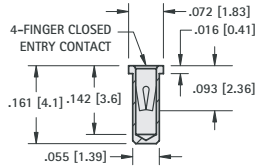

RoHS	RoHS		
GOLD	TIN/LEAD	Mtg. Hole Dia.	
CAT. NO.	CAT. NO.		
1413	1433	.057 (1.45)	

.022 (.56) - .034 (.86) PIN - PRESS-FIT

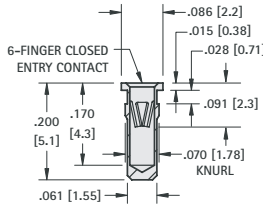

RoHS	RoHS		
GOLD	TIN/LEAD	Mtg. Hole Dia.	
CAT. NO.	CAT. NO.		
1416	1436	.067 (1.70)	

.040 (1.02) - .050 (1.27) PIN - SOLDER MOUNT

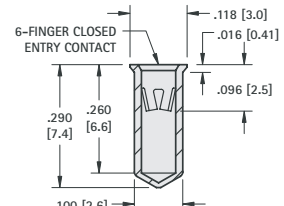

RoHS	RoHS		
GOLD	TIN/LEAD	Mtg. Hole Dia.	
CAT. NO.	CAT. NO.		
1418	1438	.102 (2.6)	

.032 (.81) - .025 (.64) PIN - SWAGE MOUNT

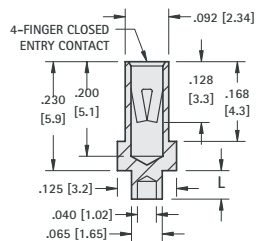

RoHS	RoHS		
GOLD	TIN/LEAD	L	Mtg. Hole Dia.
CAT. NO.	CAT. NO.	Length	
1419-1	1439-1	.062 (1.6)	.067
1419-2	1439-2	.094 (2.4)	(1.70)

.032 (.81) - .046 (1.17) PIN - SOLDER MOUNT

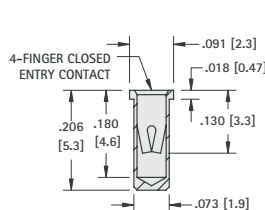

RoHS	RoHS		
GOLD	TIN/LEAD	Mtg. Hole Dia.	
CAT. NO.	CAT. NO.		
1417	1437	.076 (1.93)	

.032 (.81) - .046 (1.17) PIN - SOLDER MOUNT

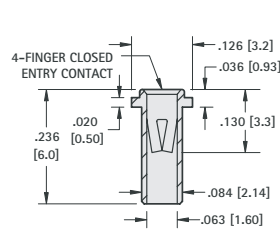

RoHS	RoHS		
GOLD	TIN/LEAD	Mtg. Hole Dia.	
CAT. NO.	CAT. NO.		
1414	1434	.089 (2.26)	

.032 (.81) - .046 (1.17) PIN - SOLDER MOUNT

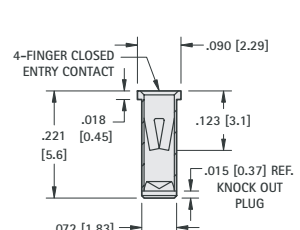

RoHS	RoHS		
GOLD	TIN/LEAD	Mtg. Hole Dia.	
CAT. NO.	CAT. NO.		
1441	1444	.076 (1.93)	

.032 (.81) - .046 (1.17) PIN - PRESS-FIT

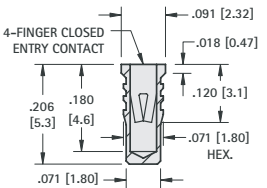

RoHS	RoHS		
GOLD	TIN/LEAD	Mtg. Hole Dia.	
CAT. NO.	CAT. NO.		
1442	1445	.076 (1.93)	

.032 (.81) - .046 (1.17) PIN - PRESS-FIT

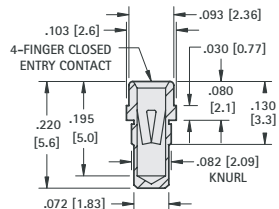

RoHS	RoHS		
GOLD	TIN/LEAD	Mtg. Hole Dia.	
CAT. NO.	CAT. NO.		
1443	1446	.078 (1.98)	

.065 (1.65) - .082 (2.08) PIN - SOLDER MOUNT

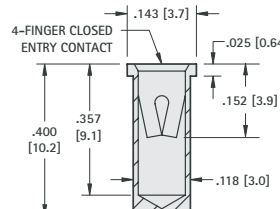

RoHS	RoHS		
GOLD	TIN/LEAD	Mtg. Hole Dia.	
CAT. NO.	CAT. NO.		
1641A	1641B	.120 (3.1)	

.084 (2.13) - .102 (2.6) PIN - PRESS-FIT

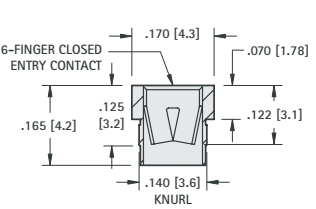

RoHS	RoHS		
GOLD	TIN/LEAD	Mtg. Hole Dia.	
CAT. NO.	CAT. NO.		
1640A	1640B	.138 (3.5)	

IC SOCKET CONTACTS For .015 (.38) - .025 (.64) LEADS - PRESS-FIT

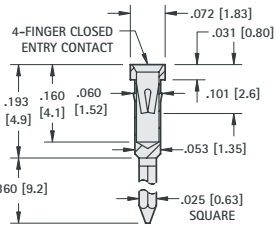

RoHS	RoHS		
GOLD	TIN/LEAD	Mtg. Hole Dia.	
CAT. NO.	CAT. NO.		
3501	3505	.055 (1.40)	

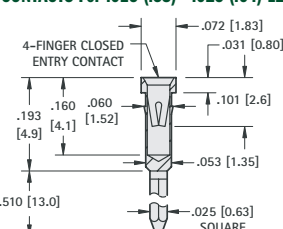

RoHS	RoHS		
GOLD	TIN/LEAD	Mtg. Hole Dia.	
CAT. NO.	CAT. NO.		
3502	3506	.055 (1.40)	

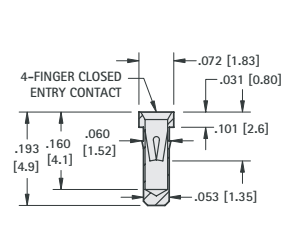

RoHS	RoHS		
GOLD	TIN/LEAD	Mtg. Hole Dia.	
CAT. NO.	CAT. NO.		
3503	3507	.055 (1.40)	