

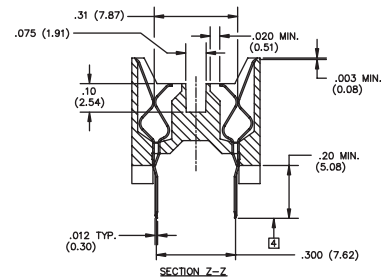

613 SERIES "MID-RISE"®

- Compact size for maximum board density
- Wide target area for easy entry and removal of IC leads
- Dual face-wipe contacts for long, dependable life
- Excellent component clearance under the socket
- Four high corner standoffs for easy inspection and cleaning of the PC board
- For temperatures up to 150°C; for higher temperature applications consult the factory

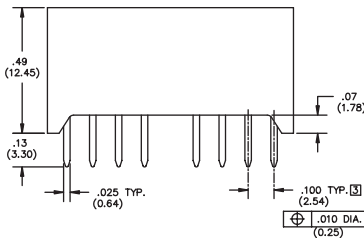
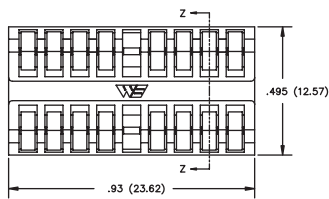
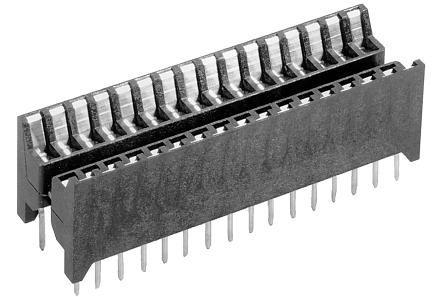

DESCRIPTION & ORDERING INFORMATION

613 - X XX XX 1 6

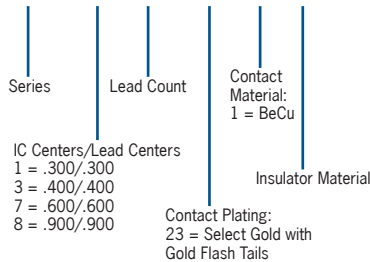

MATERIALS & SPECIFICATIONS

- Socket Body: PEI or Equivalent
- Contact: Beryllium Copper Alloy
- Contact Plating: Gold over Nickel
- Contact Insertion Force: 15 grams
- Contact Withdrawal Force: 8 grams
- Contact Resistance: 20 mΩ
- Temperature Rating: 150°C
- Dielectric: 600V AC for 2 minutes
- Durability: 10,000 cycles minutes

Lead Count	Pitch e (mm)	Package Dimensions (mm)		Part Number	Socket Dimensions (inches)			Notes
		Width (E1)	Lead Width (max) (E)		Length (A)	Width (B)	Height (C)	
6	.100 (2.54)	.270 (6.86)	.330 (8.38)	613-0062316	.330 (8.38)	.495 (12.57)	.485 (12.45)	
8	.100 (2.54)	.270 (6.86)	.330 (8.38)	613-0082316	.430 (10.92)	.495 (12.57)	.485 (12.45)	
14	.100 (2.54)	.270 (6.86)	.330 (8.38)	613-0142316	.730 (18.54)	.495 (12.57)	.485 (12.45)	
16	.100 (2.54)	.270 (6.86)	.330 (8.38)	613-0162316	.830 (21.08)	.495 (12.57)	.485 (12.45)	
18	.100 (2.54)	.270 (6.86)	.330 (8.38)	613-0182316	.930 (23.62)	.495 (12.57)	.485 (12.45)	
18	.100 (2.54)	.370 (9.40)	.430 (10.92)	613-3182316	.930 (23.62)	.595 (15.11)	.485 (12.45)	
20	.100 (2.54)	.270 (6.86)	.330 (8.38)	613-0202316	1.030 (26.16)	.495 (12.57)	.485 (12.45)	
20	.100 (2.54)	.370 (9.40)	.430 (10.92)	613-3202316	1.030 (26.16)	.595 (15.11)	.485 (12.45)	
22	.100 (2.54)	.270 (6.86)	.330 (8.38)	613-0222316	1.130 (28.70)	.495 (12.57)	.485 (12.45)	
22	.100 (2.54)	.370 (9.40)	.430 (10.92)	613-3222316	1.130 (28.70)	.595 (15.11)	.485 (12.45)	Consult Factory
24	.100 (2.54)	.270 (6.86)	.330 (8.38)	613-0242316	1.230 (31.24)	.495 (12.57)	.485 (12.45)	
24	.100 (2.54)	.570 (14.48)	.630 (16.00)	613-7242316	1.230 (31.24)	.795 (20.19)	.485 (12.45)	
28	.100 (2.54)	.270 (6.86)	.330 (8.38)	613-0282316	1.430 (36.32)	.495 (12.57)	.485 (12.45)	
28	.100 (2.54)	.370 (9.40)	.430 (10.92)	613-3282316	1.430 (36.32)	.595 (15.11)	.485 (12.45)	
28	.100 (2.54)	.570 (14.48)	.630 (16.00)	613-7282316	1.430 (36.32)	.795 (20.19)	.485 (12.45)	
32	.100 (2.54)	.270 (6.86)	.330 (8.38)	613-0322316	1.630 (41.40)	.495 (12.57)	.485 (12.45)	
32	.100 (2.54)	.370 (9.40)	.430 (10.92)	613-3322316	1.630 (41.40)	.595 (15.11)	.485 (12.45)	
32	.100 (2.54)	.570 (14.48)	.630 (16.00)	613-7322316	1.630 (41.40)	.795 (20.19)	.485 (12.45)	
40	.100 (2.54)	.570 (14.48)	.630 (16.00)	613-7402316	2.030 (51.56)	.795 (20.19)	.485 (12.45)	