

UNIVERSAL SERIAL BUS PLUGS & SOCKETS

- Snap-In PC tails hold connector in position for wave soldering
- Tin Plated solder tails for excellent solderability
- Gold Plated contacts for low contact resistance and excellent reliability

SOCKET SPECIFICATIONS:

Shell: Phosphor Bronze
Insulator: Thermoplastic, UL Rated 94V-0
Contacts: Phosphor Bronze
Contact Area: Gold Flash over Nickel
Solder Trails: Tin over Nickel

PLUG SPECIFICATIONS:

Shell: Steel, Nickel Plate
Insulator: Thermoplastic, Rated UL 94V-0
Contact: Bronze, Gold Flash over Nickel

ELECTRICAL CHARACTERISTICS

Rated Voltage: 30V (RMS)
Contact Current Rating: 1 Amp DC max.
Contact Resistance: 15 mΩ max.
Insulation Resistance: 1000 mΩ min.
Dielectric Withstanding Voltage: 750V AC for 1 minute

MECHANICAL CHARACTERISTICS

Operating Temperature: -13°F (-25°C) to 176°F (+80°C)
Durability: 1500 Cycles min.

DESIGN ADVANTAGES

Port Expansion: Alleviates restriction of limited COM Ports and available IRQ's
Fast Data Transfer: Up to 480 Mbps; 3-5 times faster than parallel devices and 20-40 times faster than serial ports.

Daisy Chaining: Up to a max. of 127 devices to the root hub

Hot-Swapping: Allows peripherals to be connected or disconnected without turning off computer

Simple Connections: True Plug and Play; No jumper, DIP Switches or IRQ's to set

True Digital Audio: Allows USB Speakers to BYPASS the sound card and receive true digital audio sound quality

DEVICE APPLICATIONS

Ability to daisy chain more than one input device

- Mouse/Keyboards
- MP3 Players
- Printers/Scanners
- Digital Cameras/Video
- Memory Sticks
- PDAs and Cell Phones

USB B-SERIES SOCKETS/PLUGS

THRU HOLE SOCKET

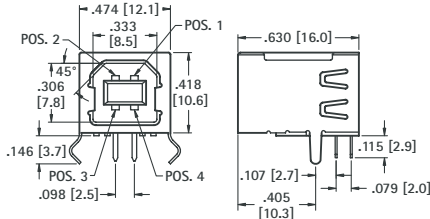

Mounting Detail

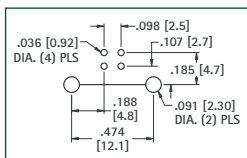

CAT. NO. 924

SURFACE MOUNT SOCKET

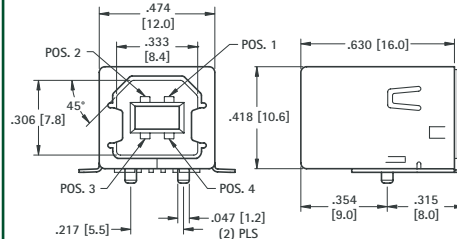

Mounting Detail

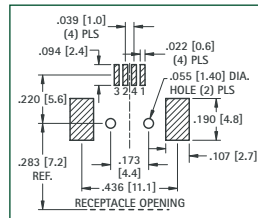

CAT. NO. 933

CABLE PLUG

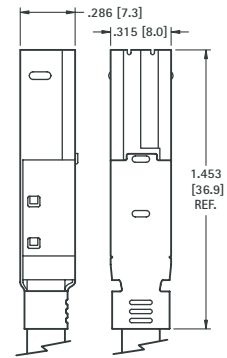

CAT. NO. 926

MINI-USB SOCKETS/PLUGS

- Ideal for Miniature applications

SURFACE MOUNT SOCKET

SUPPLIED ON TAPE AND REEL

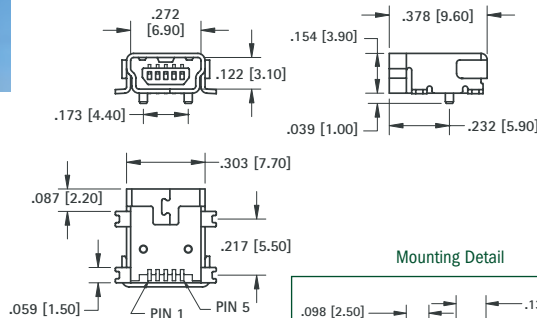

Mounting Detail

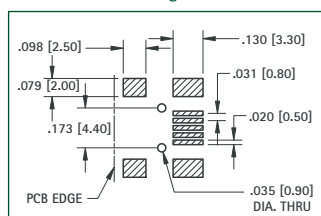

CAT. NO. 934TR

Tape & Reel Specs: 24mm wide; 16mm pitch; 13 inch reel (800 pieces per reel)

CABLE PLUG

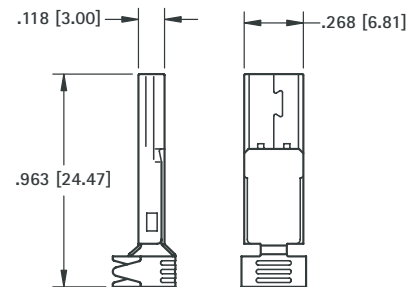

CAT. NO. 935

USB PLUGS & SOCKET

A-TYPE SOCKETS

HORIZONTAL

SURFACE MOUNT



920

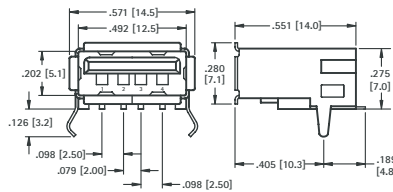

920

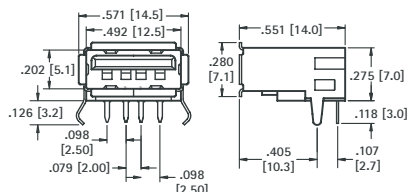

921

Mounting Detail Cat. No. 920

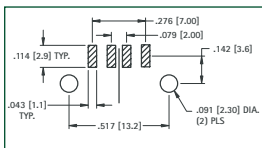

CAT. NO. 920

Mounting Detail Cat. No. 921

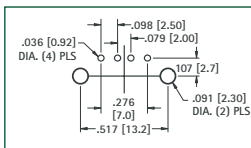

CAT. NO. 921

VERTICAL

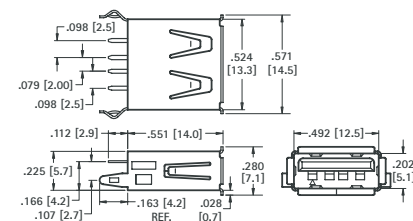

Mounting Detail

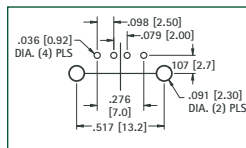

CAT. NO. 923

DUAL STACKING

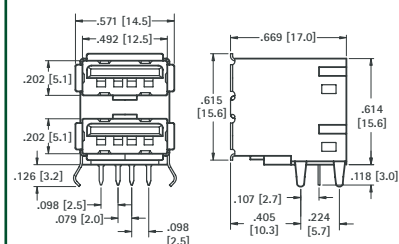
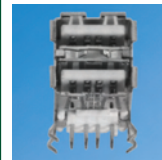

Mounting Detail

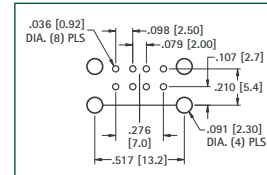

CAT. NO. 922

A-SERIES PLUGS

FEATURES

- Available for on-board applications such as memory sticks
- Cable clamp style for creating custom cables
- Gold plated contacts for low contact resistance and excellent reliability

SURFACE MOUNT

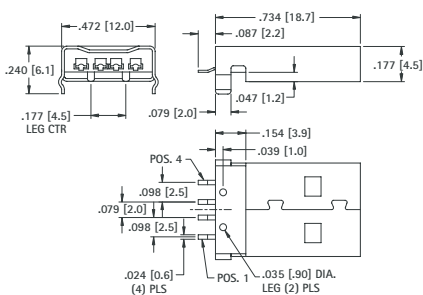

Mounting Detail

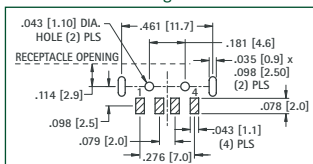

CAT. NO. 931

THRU HOLE MOUNT

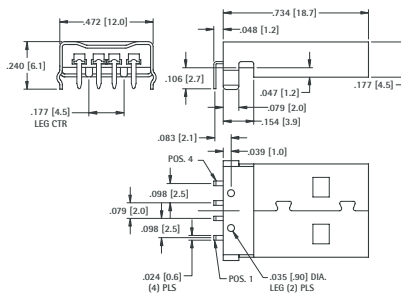

Mounting Detail

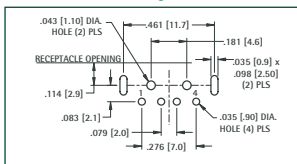

CAT. NO. 932

CABLE PLUG

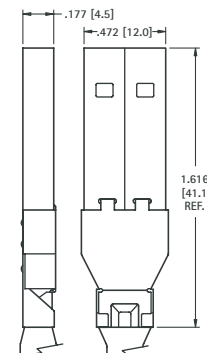

CAT. NO. 925